

# Anchored PowerSleeper™

## FIXED RESILIENT SYSTEMS

Anchored PowerSleeper™ is an anchored system that fully engages the resilient pad ensuring uniform performance and increased structural stability. This system combines pre-engineered sleepers with a plywood underlayment for greater dimensional strength and stability. It is suitable for new and retrofit sports floor applications and commercial projects.



INFINITY  
Wood Floors



# Anchored PowerSleeper™

Anchored PowerSleeper™ is the perfect, traditional basketball floor where maximum performance and structural integrity are essential.



1. Infinity MFMA Maple
2. 15/32" (12mm) Exposure 1, APA Rated Sheathing
3. Pre-Engineered Plywood Sleeper
4. ECO Pad
5. Non-Squeak Anchor & Washer

## WALL BASE

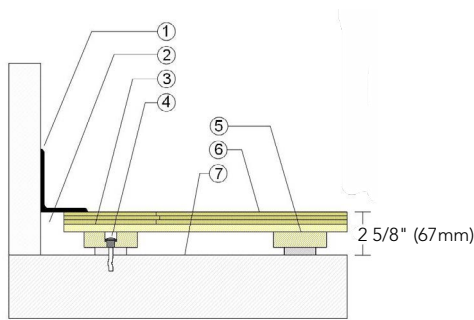

1. 3" x 4" (76mm x 101mm) Vent Cove Base
2. 1-1/2" (38mm) Min. Expansion Space
3. 15/32" (12mm) Plywood Subfloor
4. Steel Concrete Anchor and Bushing
5. Engineered Plywood Sleeper with 1/2" (12mm) ECO Resilient Pads
6. 25/32" (20mm) MFMA Maple Flooring
7. Vapor Retarder

## THRESHOLD

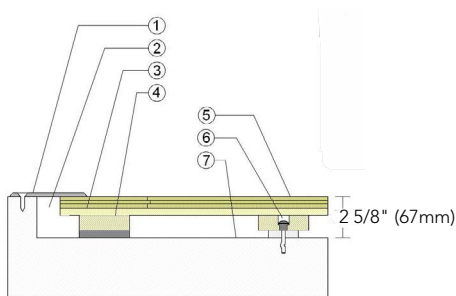

1. 1/4" (6mm) Aluminum Threshold
2. 1-1/2" (38mm) Min. Expansion Space
3. 15/32" (12mm) Plywood Subfloor
4. Engineered Plywood Sleeper with Solid Blocking Attached
5. 25/32" (20mm) MFMA Maple Flooring
6. Steel Concrete Anchor and Bushing
7. Vapor Retarder

## EQUIPMENT

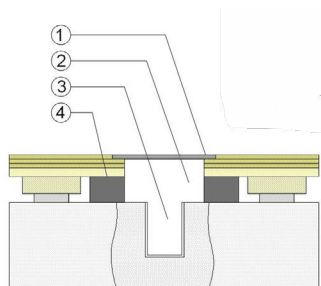

1. Floor Plate
2. 1 1/2" (38mm) Min. Expansion Space at all Insert & Electrical Penetrations
3. Concrete Floor Penetration
4. Solid Blocking at Insert

## Anchorage

### Certified



### Green Status and LEED Contributors



- FSC® Certified Maple - MR
- FSC® Certified Subfloor Components - MR
- Environmental Quality - EQ
- Regional Materials - MR

### Resilience

1/2" (12mm) ECO Pad  
\*Other pad options available.

### Slab Depression

- 25/32" (20mm) flooring  
-2 5/8" (67mm)

### System Type

Fixed Resilient

### Optional PowerSleeper Systems

Anchored PowerSleeper SE  
Anchored PowerLoc LP  
Anchored PowerLoc

### Subfloor Construction

Sleeper Plywood

### Optional Protection System

PowerVent  
Airflow System

### Testing Laboratory Partners



It is the policy of Infinity Wood Floors to continuously improve its line of products. Therefore, Infinity Wood Floors reserves the right to change, modify or discontinue systems, specifications and accessories of all products at any time without notice or obligation to purchaser.



see us at  
**Sweets.com**

